

C 175 - 147

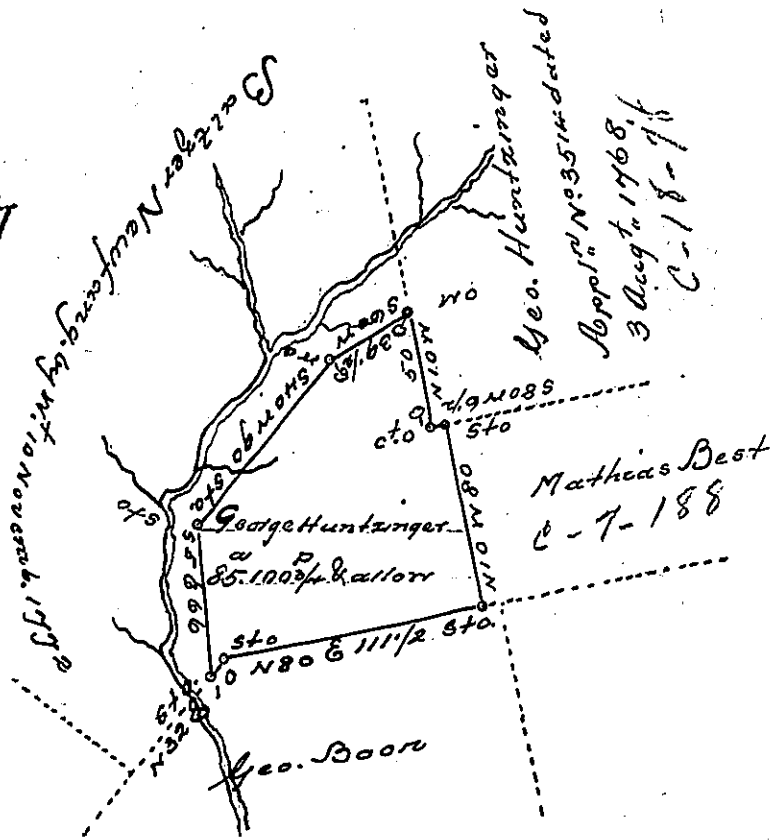

Situate in Marheim Township Schuyl Kill, containing 85.100 3/4 ^{A P} allowance
of six per cent for Roads. Surveyed on the 8th day of August A. D. 1828. by
virtue of a Warrant granted to George Huntzinger, dated the 22^d day of
March A. D. 1775.

To the Hon^{ble} the Board of Property Geo. Reber
John Eiler

No Draught to shew the date of the above survey
but by the line trees, it appears that the Survey was made in 1784, the
line on the South West side also appears to have been made in 1766, or
later in the year 1765

Present Owner
Jacob Reber
John Eiler

Actual Survey who resides on it

IN TESTIMONY that the above is a copy of the original remaining on file in
the Department of Internal Affairs of Pennsylvania, made
conformably to an Act of Assembly approved the 16th day of
February, 1833, I have hereunto set my Hand and caused
the Seal of said Department to be affixed at Harrisburg,
this ninth day of May, 1905,

Isaac R. Reber
Secretary of Internal Affairs.